

**PUSH-OPEN FULL EXTENSION
BALL BEARING SLIDE**
三节反弹滚珠滑轨

SH4605FR PUSH-OPEN FULL EXTENSION BALL BEARING SLIDE
三节反弹滚珠滑轨



- 全拉出、可拆式反弹三节钢珠滑轨
- 滑轨宽度: 45.7mm
- 载重: 36kg
- 表面处理: 电泳、电镀
- 材质: 冷轧钢板
- 材料厚度(内、中、外)轨: 1.5x1.2x1.2mm

- Full-extension, push to open
- Slide width: 45.7mm
- Dynamic load capacity: 36kg
- Finish: electrophoresis, plating
- Material: cold rolled steel
- Thickness of material(I/M/O)part: 1.5x1.2x1.2mm

滑轨安装尺寸 Installation size

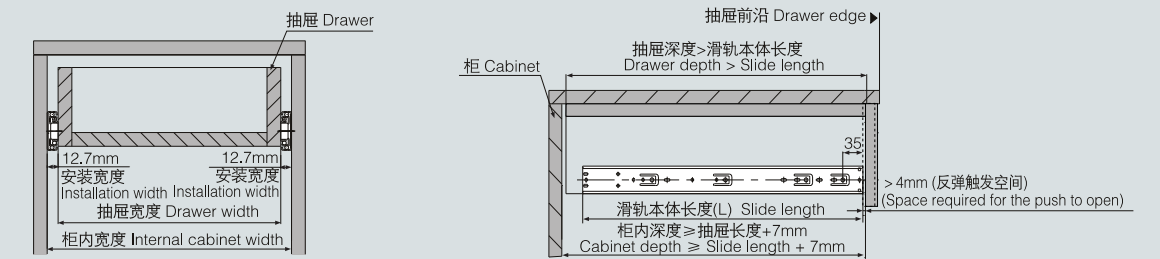

滑轨截面图 Profile

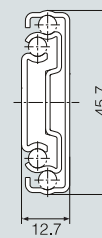

滑轨安装孔尺寸 Hole pattern

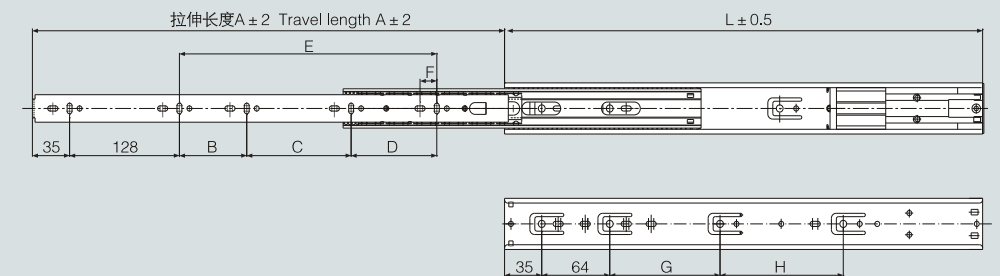

产品型号 Item No.	Length mm	A mm	B mm	C mm	D mm	E mm	F mm	G mm	H mm	L mm
SH4605FR-300	300	251								300
SH4605FR-350	350	351								350
SH4605FR-400	400	401								400
SH4605FR-450	450	451						160		450
SH4605FR-500	500	501	64	192				160		500
SH4605FR-550	550	551	64	192	54.6	310.6		160		550
SH4605FR-600	600	601	64	224	64	352	16	160	128	600